

# Mercury PRO watsonconsoles

## DISPATCH USER WIRE-UP GUIDE

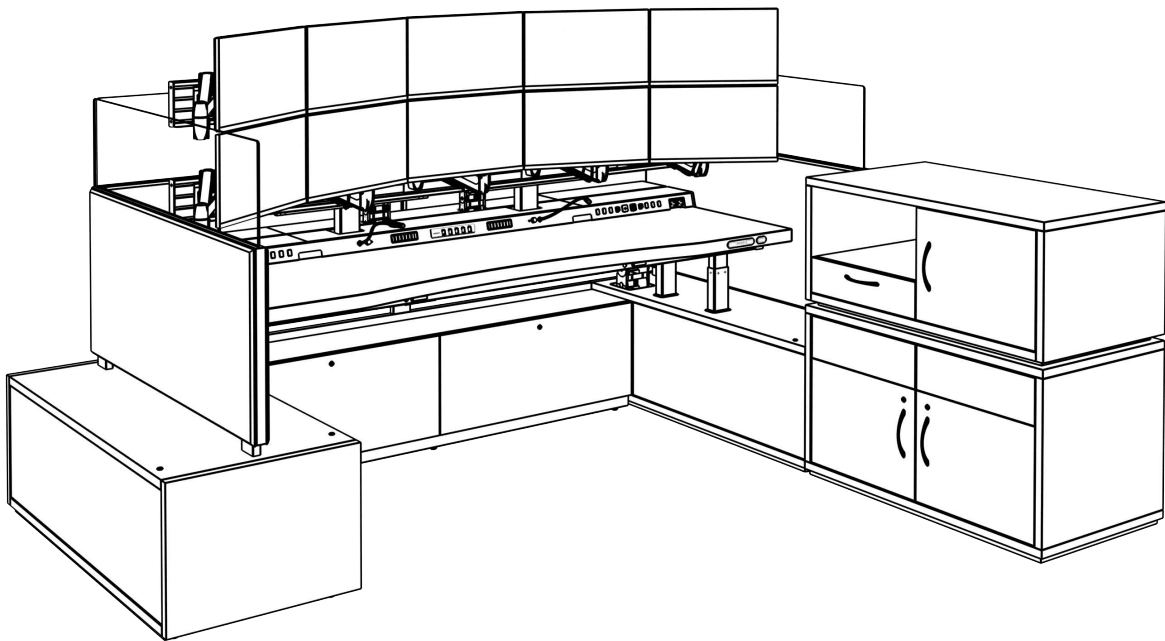

# PRODUCT TYPICAL

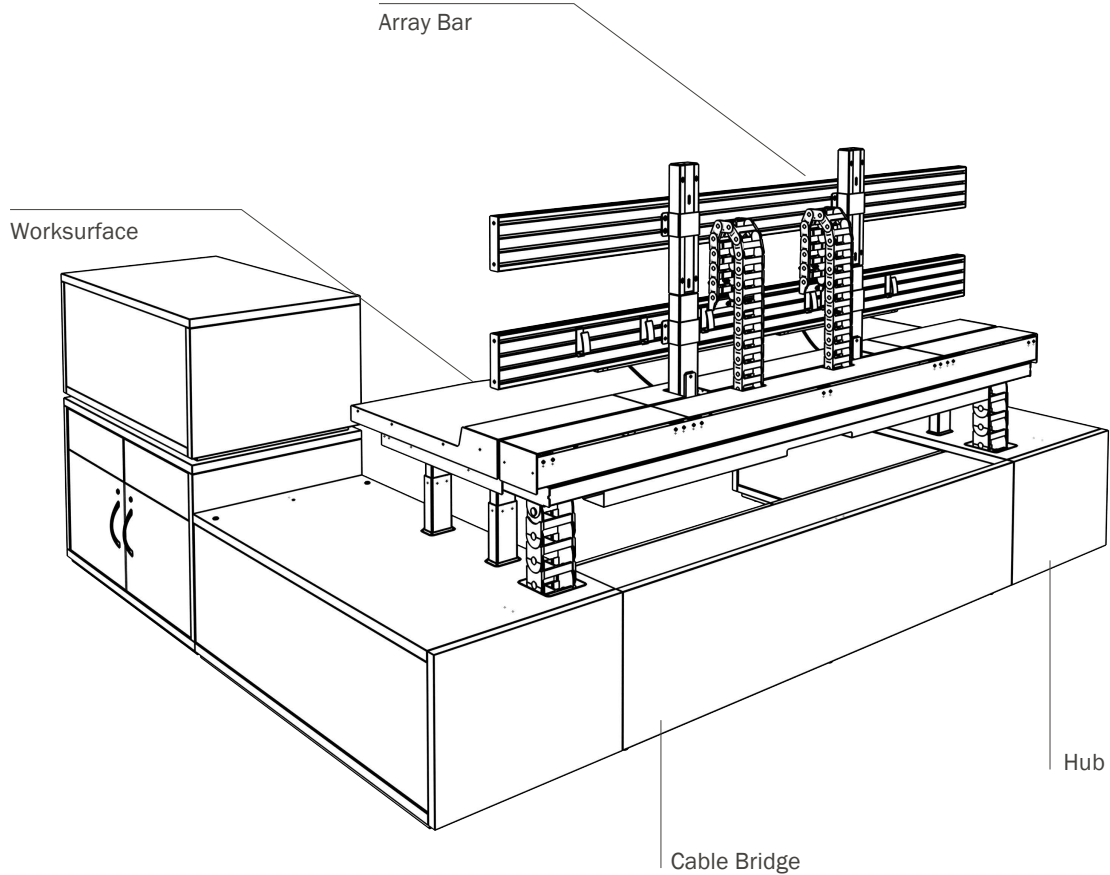

## GETTING STARTED

### Check connections:

Make sure your MERCURY worksurface power cord is plugged into a 110 volt power source. Note: The Wellness Switch display will light up to indicate the control box is plugged in.

### Clear area:

Reduce height-adjustment interference by removing objects from beneath the worksurface and on top of the hubs. Keep these areas clear to prevent injury and damage when the worksurface is at its lowest setting.

### Duty Cycle:

Regardless of load, the duty cycle of this system includes a maximum of five minutes operation per hour, or a maximum of two minutes of continuous use. The controller software restricts the motor from exceeding these limits. This prevents damage to the motor and extends the life of the system.

## ADJUSTING THE TABLE

### Normal Operation:

To run the worksurface up or down, press and hold the UP or DOWN button, until the worksurface reaches the desired height. The same can be done for the array bar using the UP and DOWN arrows for the array. Note: If the control box makes noise or emits an odor during operation, unplug the power cord immediately and call customer service at (360) 394-1300

## 1. Monitor Power Cables

With the monitor height set at the highest position and monitor arms set to their fully extended position, run all monitor power cables down the nearest monitor energy chain and along the rear dash. Plug the power cords into the nearest in-dash power strip.

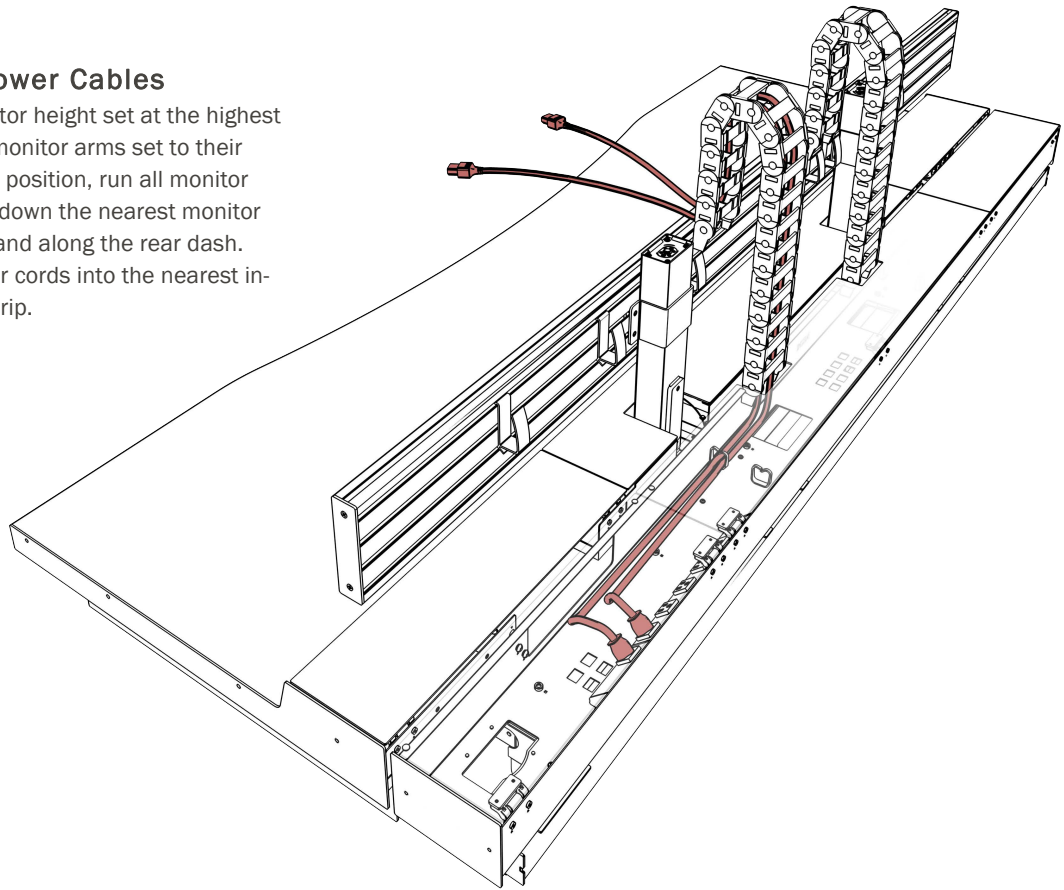

## 2. Monitor Display Cables

Run all monitor display cables down the nearest monitor energy chain and along the rear dash.

Use the cable clips shown below to route the cables through the underside of the rear dash and into the energy chain located below the worksurface.

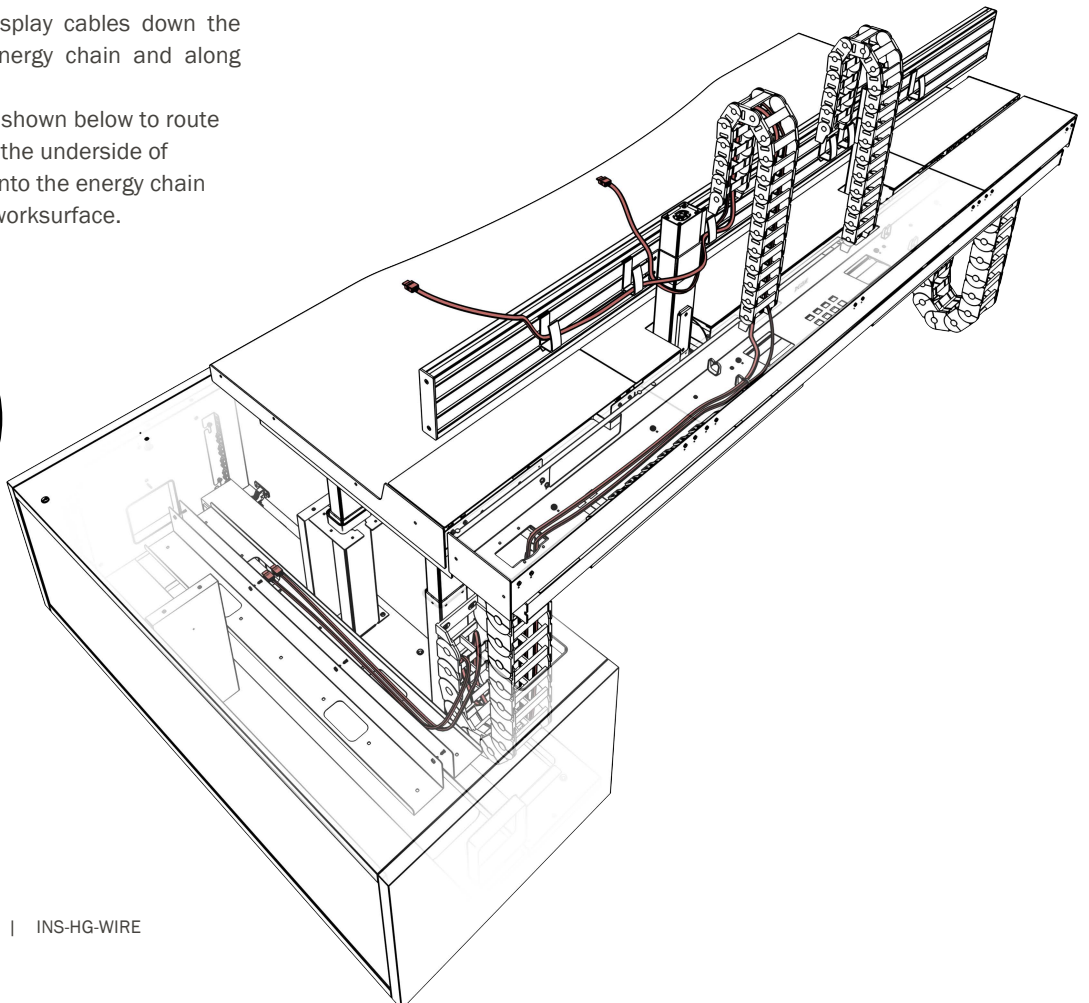
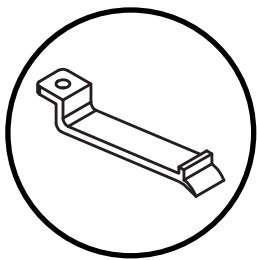

3. With the worksurface height near the upper limit, continue running the cables down the worksurface energy chain, through the hub, and into the technology cabinets.

Make sure when running cables through the worksurface energy chains to always run the cables through every link of the energy chain and out the end of the energy chain. The enlarged diagram below shows the correct way to route your cables. Failure to route your cables in the described manner can result in cable pinching or detachment.

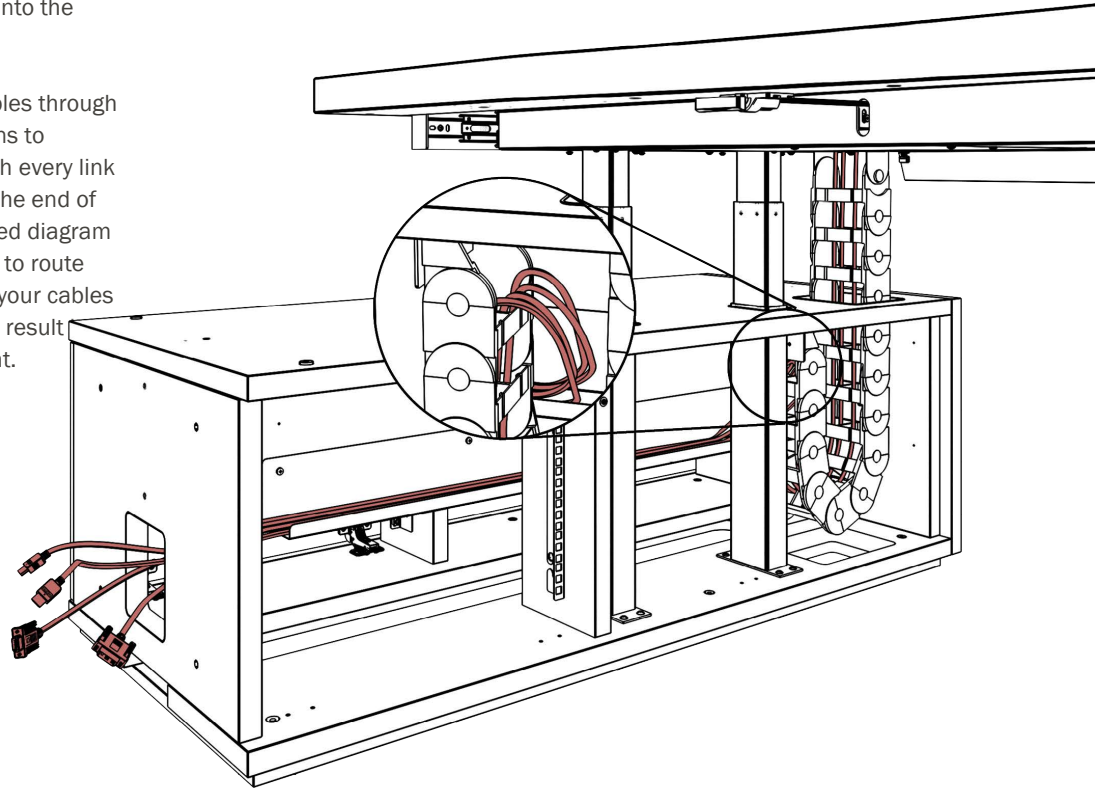

#### 4. User Data Cables

- (1) Fully extend the worksurface toward the user and plug the user data cables into their respective ports on the back side of the front dash.
- (2) Route all user data cables through the horizontal energy chain, making sure to secure the cables to the front dash.
- (3) Continue to route the cables down through the rear cable drop and energy chain. Route the cables horizontally through the hub in the same manner as the video cables.

**IMPORTANT NOTE** – To limit the number of extensions or adapters required, USB cables should be plugged into the same side as the technology cabinet in which they will terminate. If you have to plug the USB cable on the opposite side as the technology cabinet, you must attach either an active USB booster or a cat6 adapter to ensure a stable signal. Refer to the Cable Buying Guide for more information.

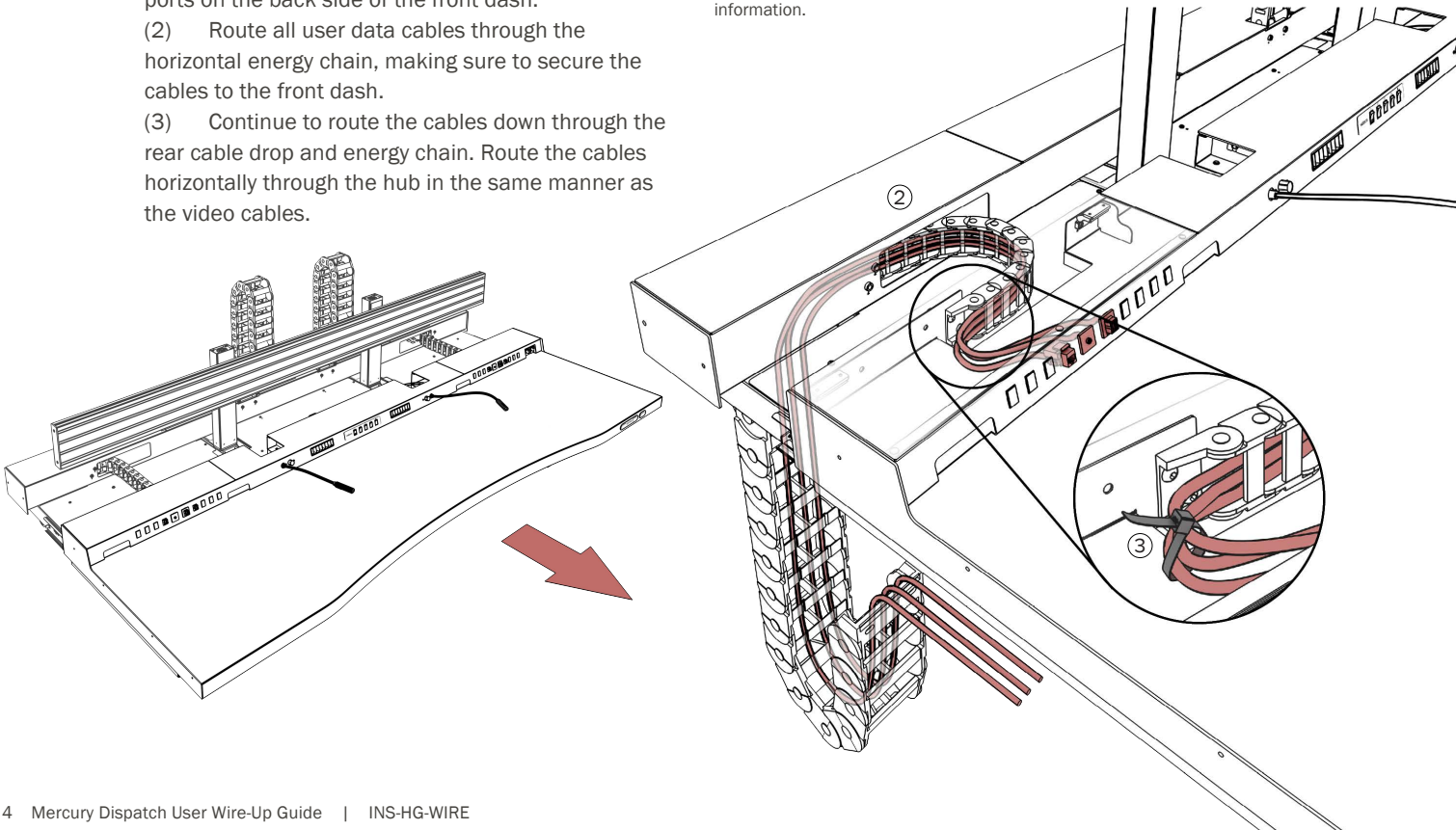

## 5. 110V Convenience Power

(Optional)

Route the convenience power outlet cord through the horizontal energy chain, making sure to utilize the provided strain relief. Continue to route the cable down the energy chain and plug into facility power.

Make sure convenience power is not plugged into the computer equipment power strips.

